

Specification:

Credenza power unit option:

- 10' power cord provides sufficient length to route through credenza.
- Top power one location cutout code YECU

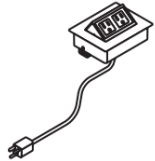

Glenbeigh
Power, Corded
[9PCK2C]

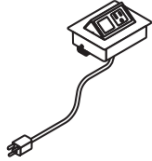

Glenbeigh
Power + Open, Corded
[9PCK1C]

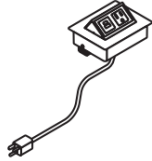

Glenbeigh
Power + USB, Corded
[9PCK11C]

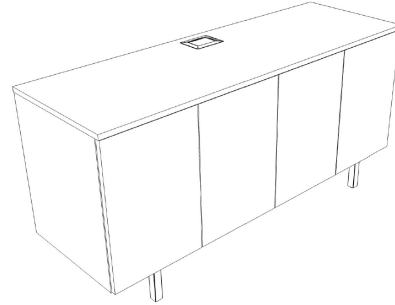

Glenbeigh corded units

Content: item (quantity)

- Glenbeigh power unit (1)
- metal attachment clips (2)
- plastic corner latches (2)
- 12 pack data adapter kit (1) 9PCK1C only



Glenbeigh Power Unit
(9PCK1C shown)



Metal Clips

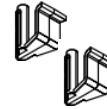

Plastic Latches

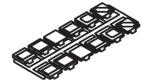

12 pack adapter kit
(9PCK1C only)

NOTE: no tools required for installation

Step 1 - Glenbeigh installation to credenza top

1. Attach 1 clip, at front and back of unit base with short leg of clip sliding to inside of unit.
2. Route Glenbeigh unit power cord through top cutout as power unit is lowered into opening. As unit is pushed into the opening the clips will grip the top material wall.
3. Insert the plastic corner latches into the base of the unit, push up until contact is made with the bottom side of the surface, rotate to secure in position.



Detail 1

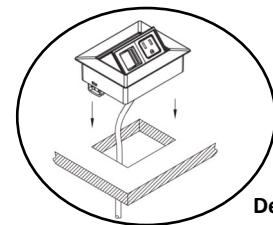

Detail 2

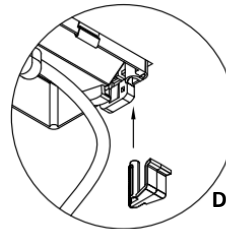

Detail 3

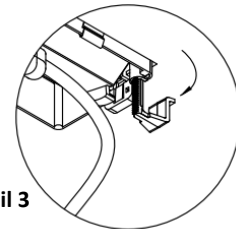

Step 1 - Glenbeigh 12 pack adapter kit for 9PCK1C units only

1. Select adapter or blank cover for unit open window. The 12-pack data adapter kit has been provided with **9PCK1C** unit to support a variety of data connection options.

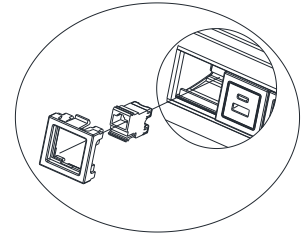
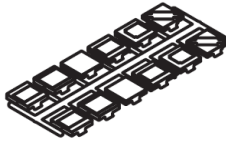

Detail 1

Securing Cables

1. Install adhesive cable mounting clips to underside of cabinet top to route cord to one of the back panel openings. Position clips along cord ensuring there is adequate slack to allow the unit to open properly and twist the cable mounting clip loops clockwise to latch.

Cable Mounting Clips

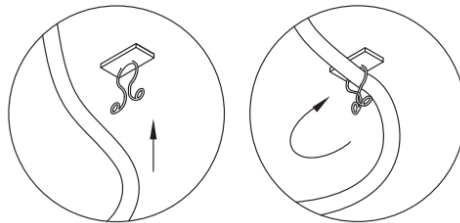

Detail 1

Power Plug Connection

1. Plug power cord into building power source and check unit outlets to verify power.

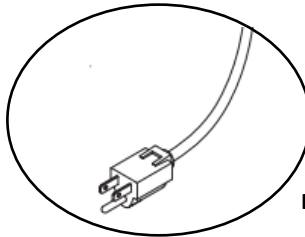

Detail 1